

ET-1212 (12V 12AH)

Valve-regulated Lead Acid Battery Specification

Features

- Maintenance free
- Safety and no leakage
- Excellent recharge and discharge performance
- Low self-discharge rate
- Adapt to high or low temperature
- Good deep discharge performance
- Longer cycle life



Specification

Rated Voltage	12V
Numbers of cells	6 Cells
Capacity	12Ah@20hr-rate to 1.80V per cell @25°C
Weight	3.7kg
Internal Resistance	Approx. 20 mΩ
Terminal	F2
Max. Discharge Current	180A(5s)
Short Circuit Current	600A
Max. Charging Current	3.6A
Reference Capacity	C20 12AH C5 10AH C1 7.1AH
Design Life	6~8 years
Float Charging Voltage	13.6 V~13.8 V @ 25°C Temperature Compensation: -20mV/°C/Cell
Cycle Use Voltage	14.4 V~14.9 V @ 25°C Temperature Compensation: -30mV/°C/Cell
Operating Temperature Range	Discharge: -15°C~50°C Charge: 0°C~40°C Storage: -15°C~40°C
Normal Operating Temperature Range	25°C±5°C
Self Discharge	Less than 3% at 25°C per month
Container Material	A.B.S. UL94-HB, UL94-V0

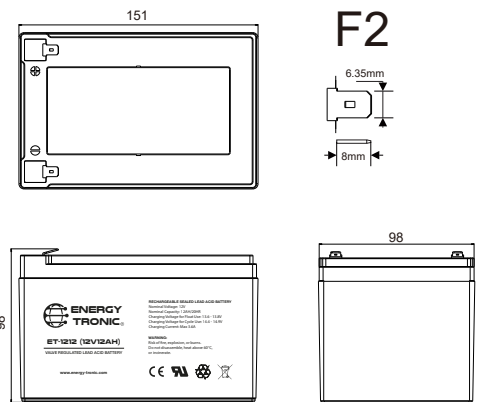

Length	151±2mm (5.9 inches)
Width	98±1mm (3.9 inches)
Height	94±1mm (3.7 inches)
Total Height	98 ±1mm (3.9 inches)

Constant Current Discharge Characteristics : A(25°C)

F.V/Time	5min	10min	15min	20min	30min	45min	1h	3h	5h	10h	20h
1.80V/cell	30.70	22.40	17.60	14.90	11.50	8.33	6.76	3.00	1.99	1.12	0.60
1.75V/cell	34.60	24.60	19.20	16.00	11.90	8.64	7.07	3.06	2.04	1.15	0.61
1.70V/cell	38.10	26.90	20.50	16.80	12.40	8.99	7.29	3.15	2.09	1.17	0.62
1.65V/cell	42.00	29.00	21.80	17.80	13.10	9.21	7.46	3.28	2.15	1.19	0.625
1.60V/cell	46.30	31.50	23.30	19.00	13.80	9.60	7.54	3.38	2.22	1.21	0.629

Constant Power Discharge Characteristics : WPC(25°C)

F.V/Time	5min	10min	15min	20min	30min	45min	1h	3h	5h	10h	20h
1.80V/cell	55.50	40.90	32.30	27.60	21.50	15.90	13.00	5.82	3.88	2.21	1.19
1.75V/cell	61.20	44.30	34.90	29.40	22.20	16.30	13.50	5.91	3.97	2.26	1.20
1.70V/cell	65.60	47.10	36.70	30.70	22.90	16.90	13.90	6.06	4.06	2.31	1.22
1.65V/cell	71.30	50.40	38.70	32.30	24.00	17.20	14.10	6.29	4.16	2.35	1.23
1.60V/cell	76.80	53.50	40.80	34.10	25.20	17.80	14.20	6.45	4.28	2.37	1.24

ET-1212 (12V 12AH)

Valve-regulated Lead Acid Battery Specification

Charge Characteristics for Float Use @ 25°C/77°F

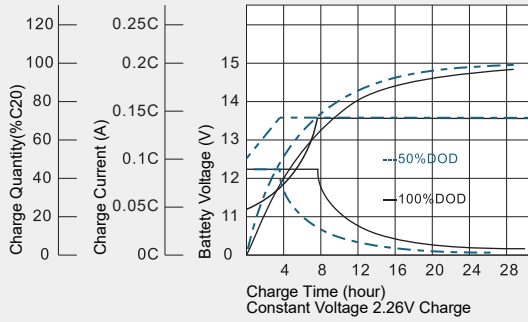

Discharge Characteristics at Various Rates @ 25°C/77°F

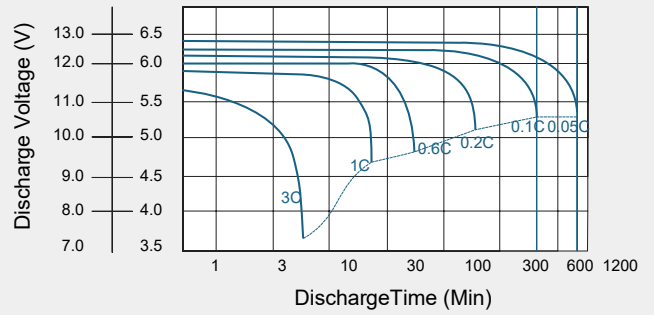

Cycle Life in Relation to Depth of Discharge

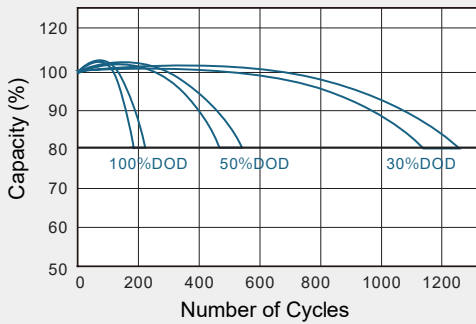

Float Service Life

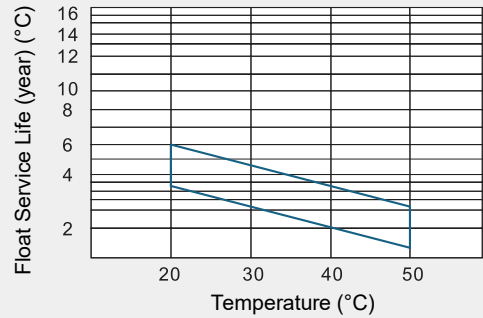

Temperature and Valid Capacity

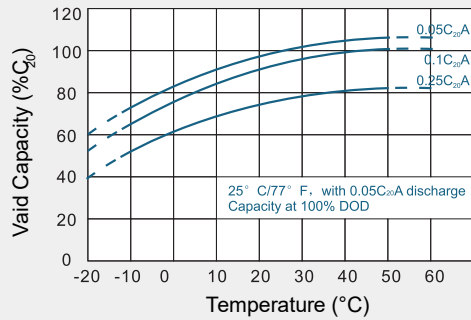

Self Discharge Characteristics

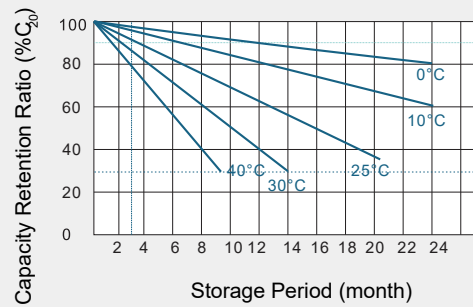

Capacity and Open Circuit Voltage

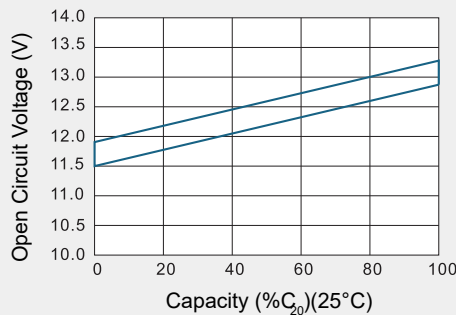

Relationship between Charging Voltage and Temperature

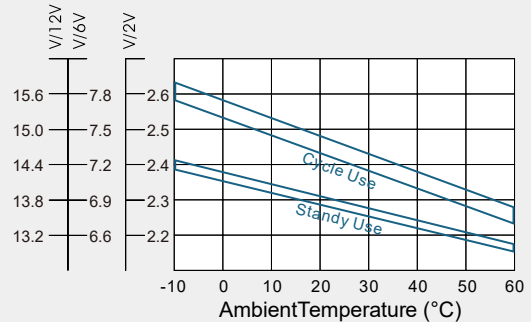

CN02/0326

